

SEZ TIPO 01
PIAZZOLA SCUOLABUS
1:20

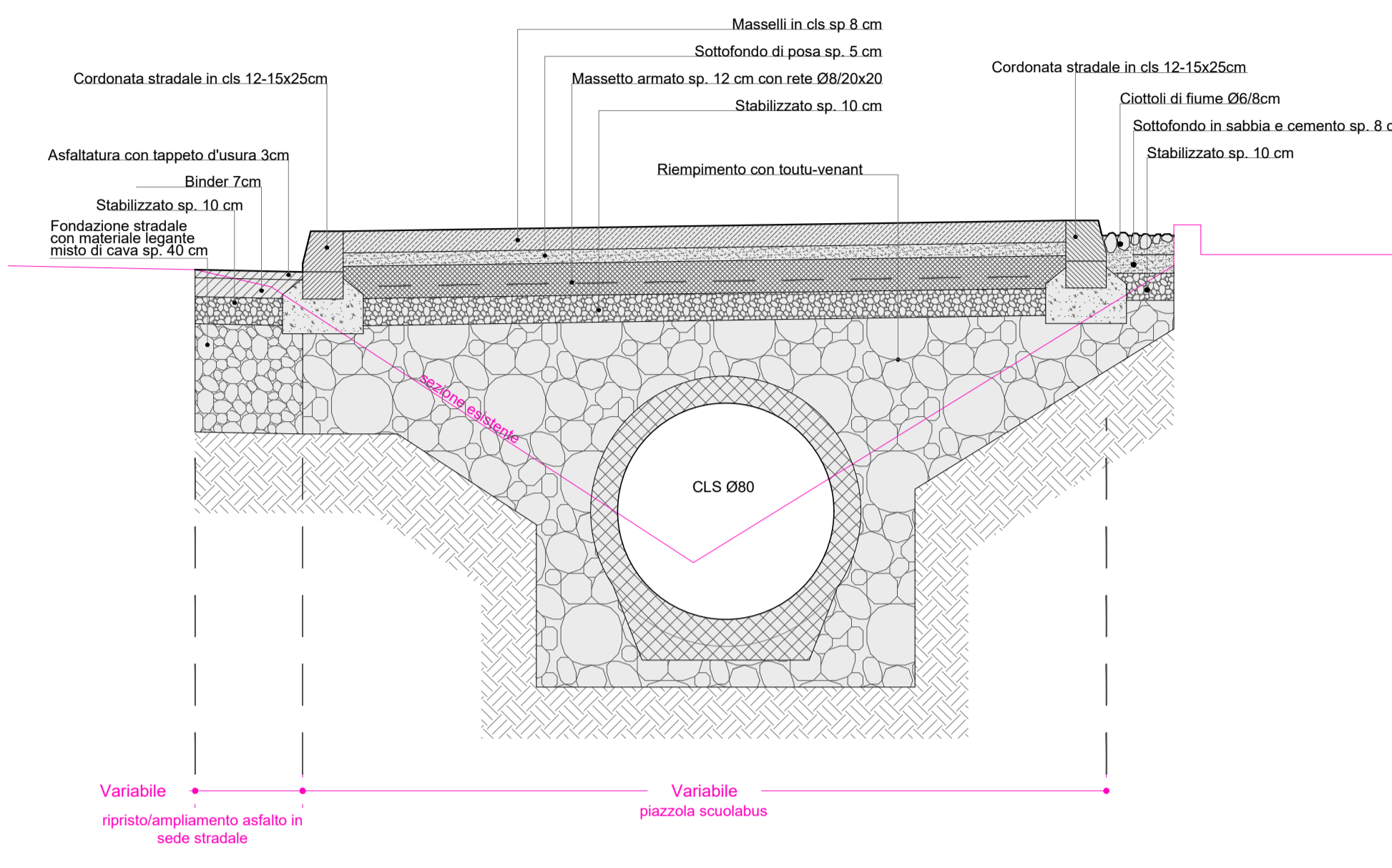

PLAN TIPO 01
PIAZZOLA SCUOLABUS
1:20

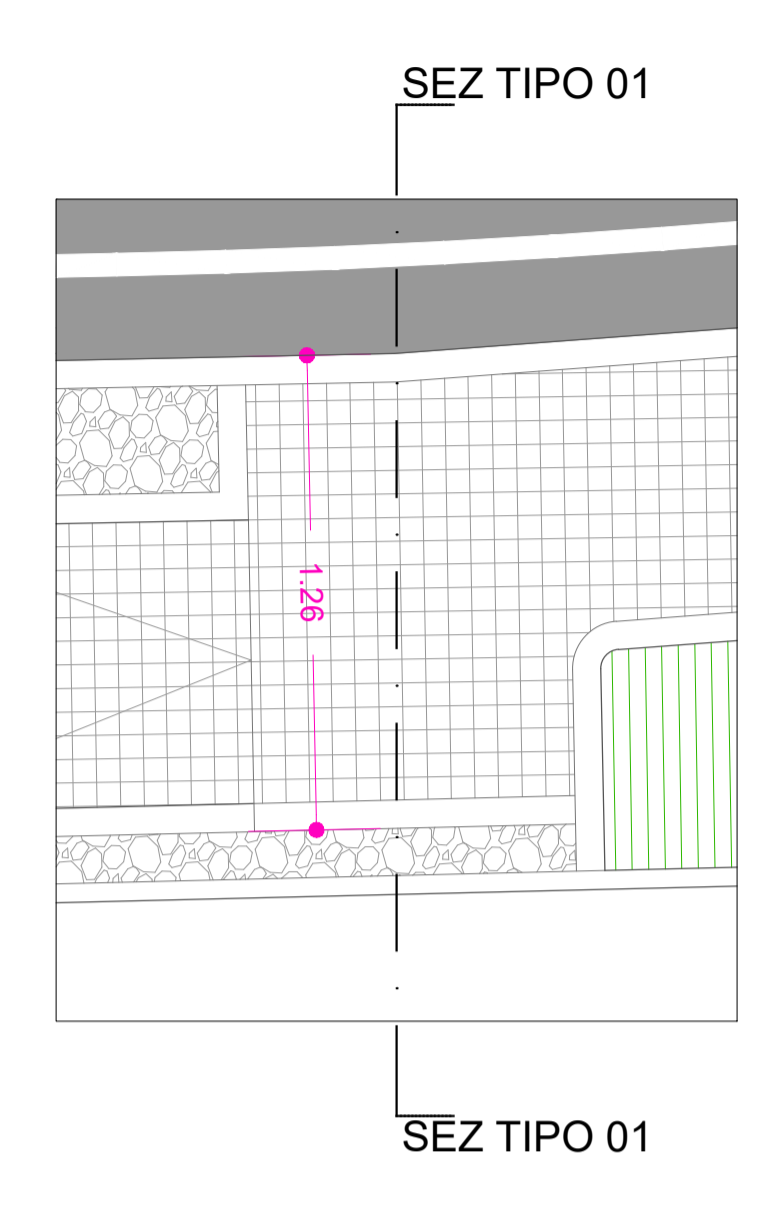

SEZ TIPO 02
MARCIAPIEDE CON AIUOLA
1:20

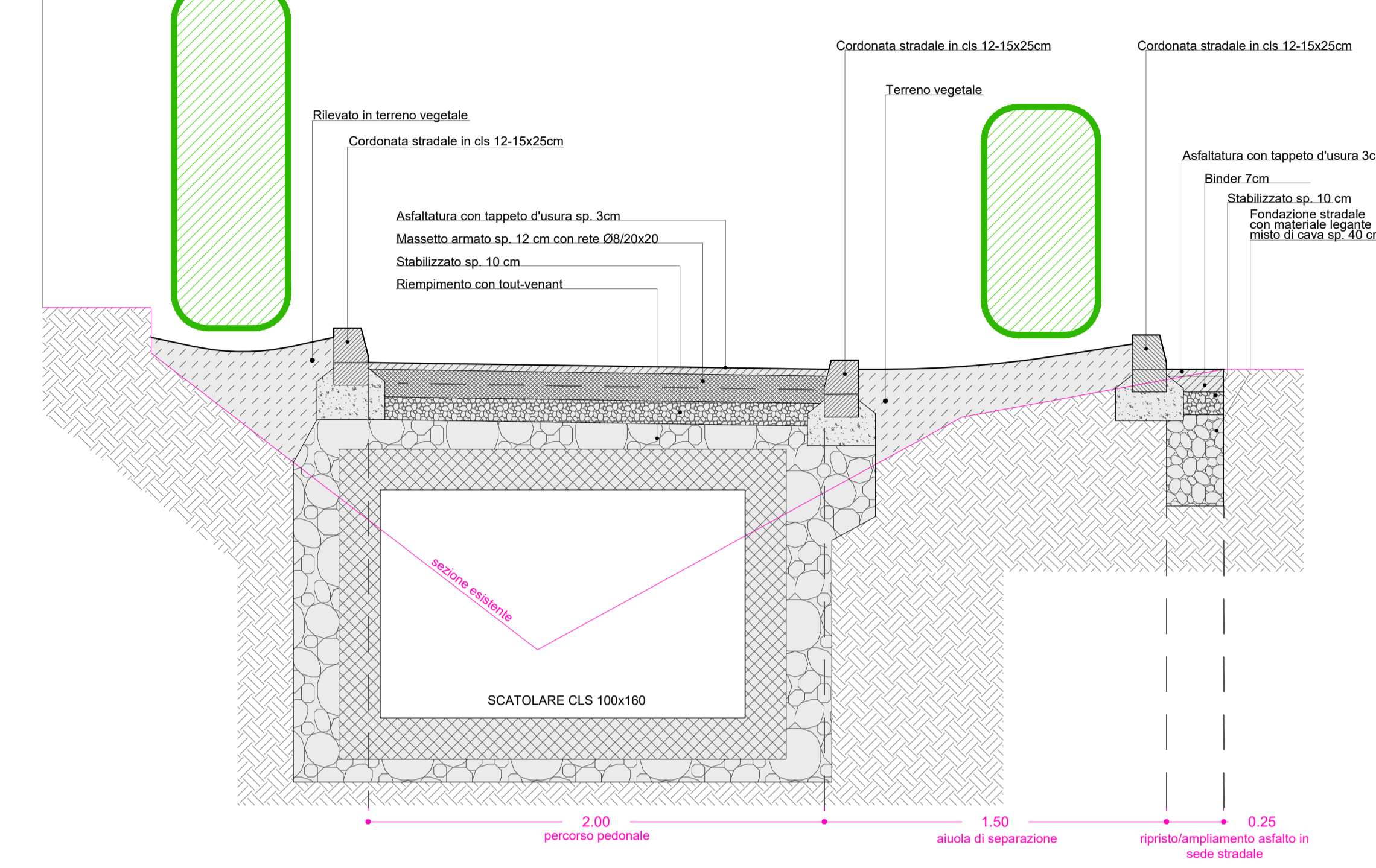

PLAN TIPO 02
MARCIAPIEDE CON AIUOLA
1:20

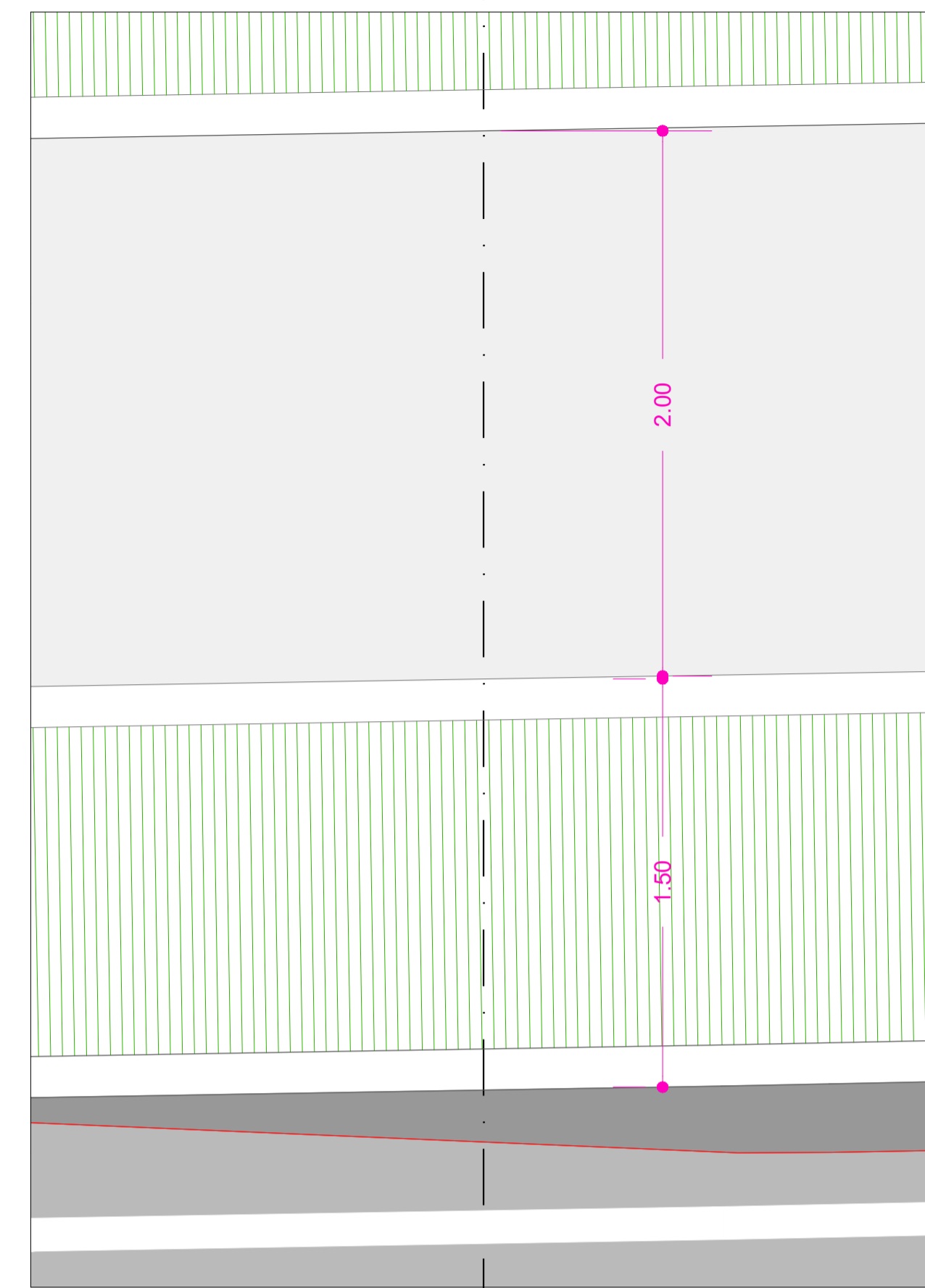

SEZ TIPO 02

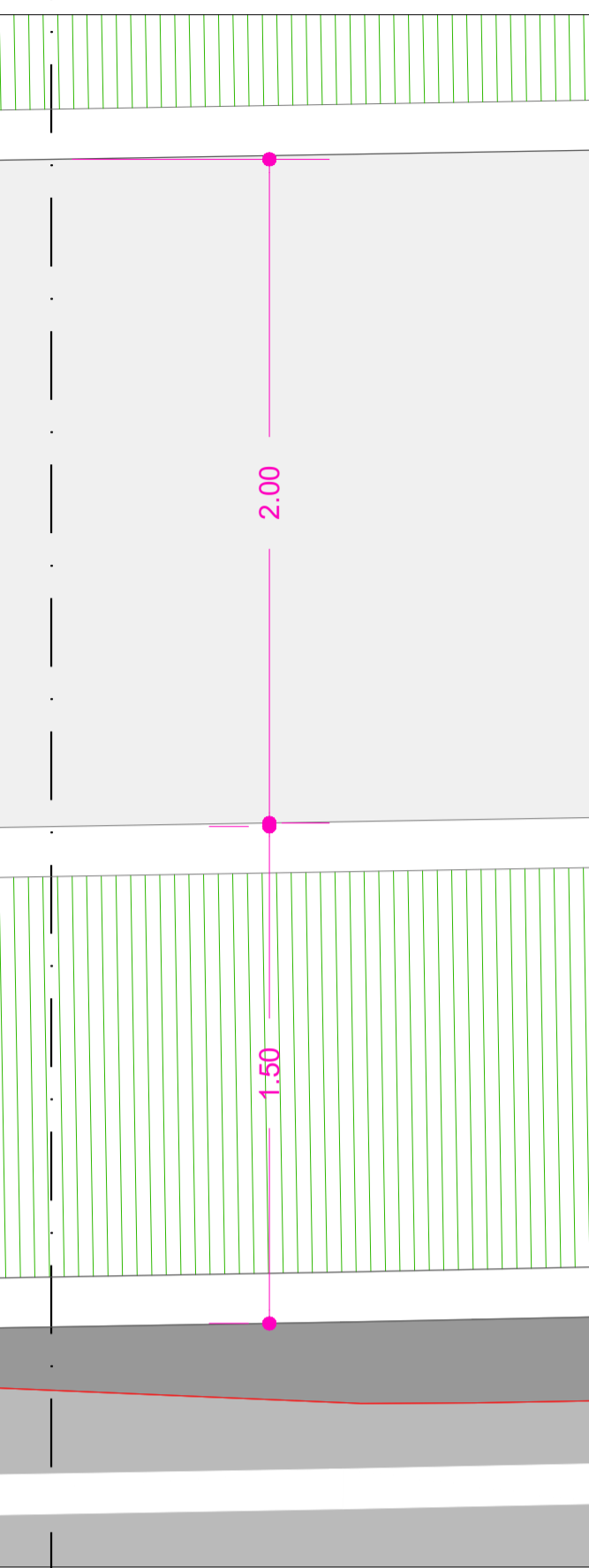

SEZ TIPO 02

SEZ TIPO 03
MARCIAPIEDE CON CORDOLO
1:20

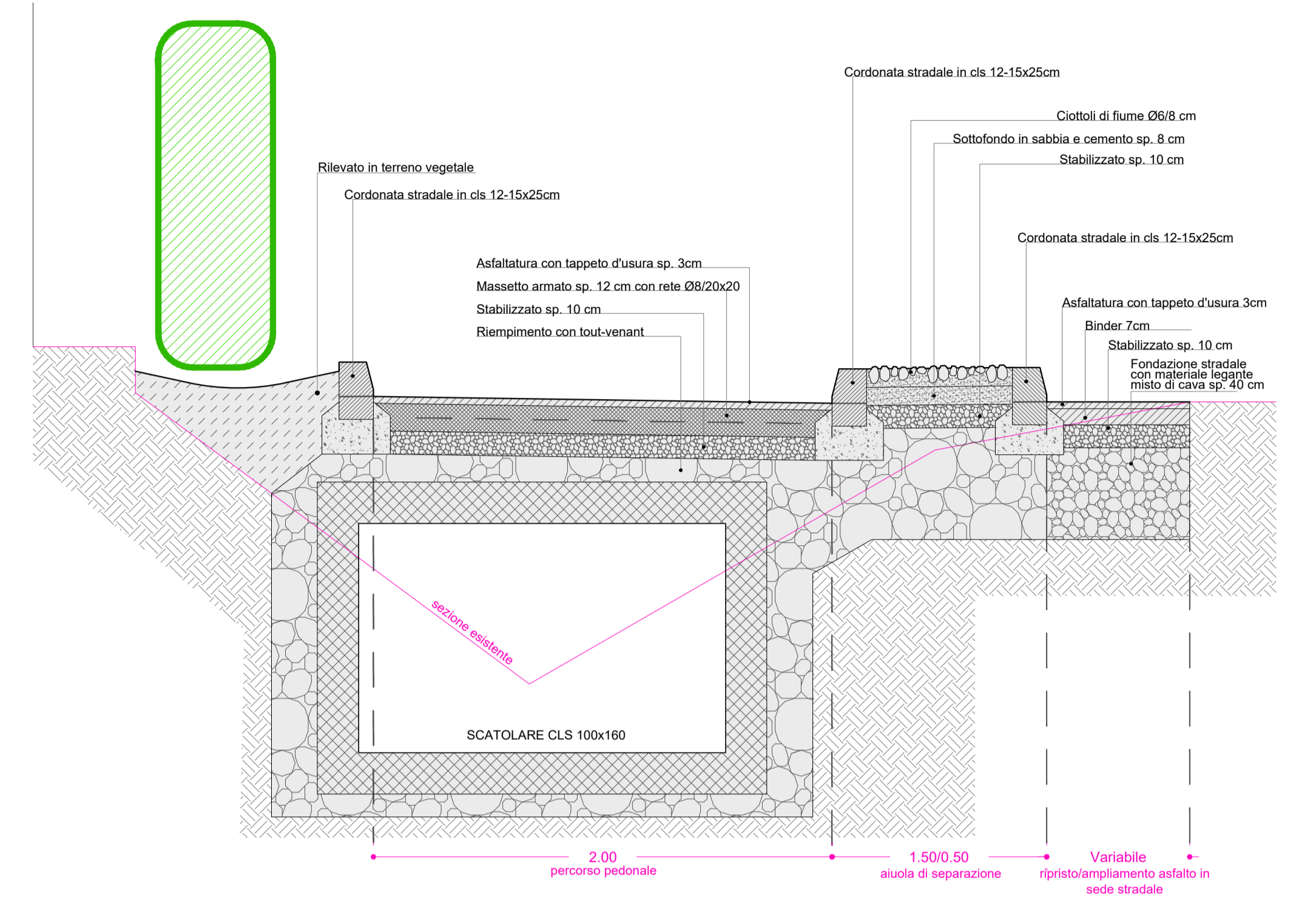

PLAN TIPO 03
MARCIAPIEDE CON CORDOLO
1:20

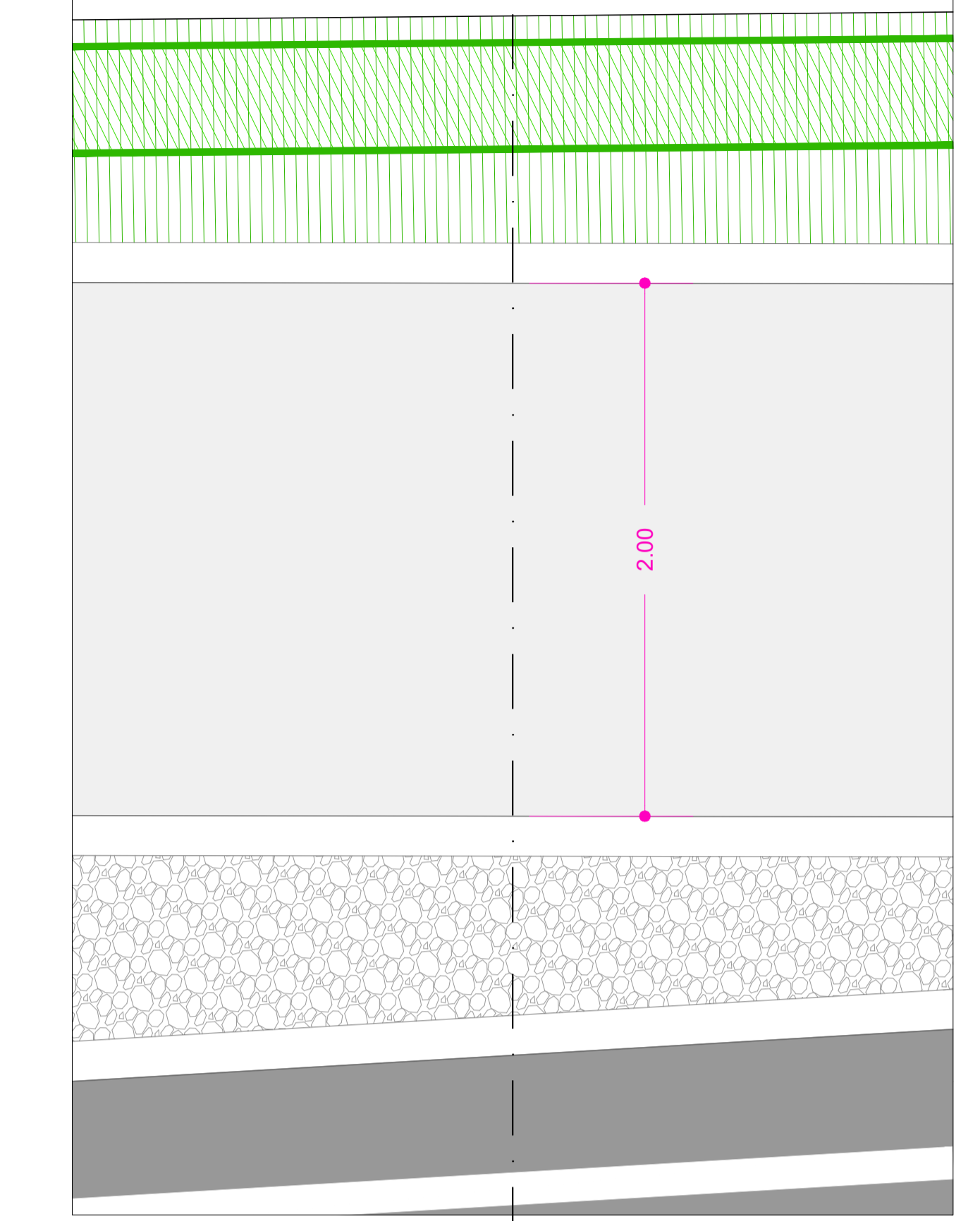

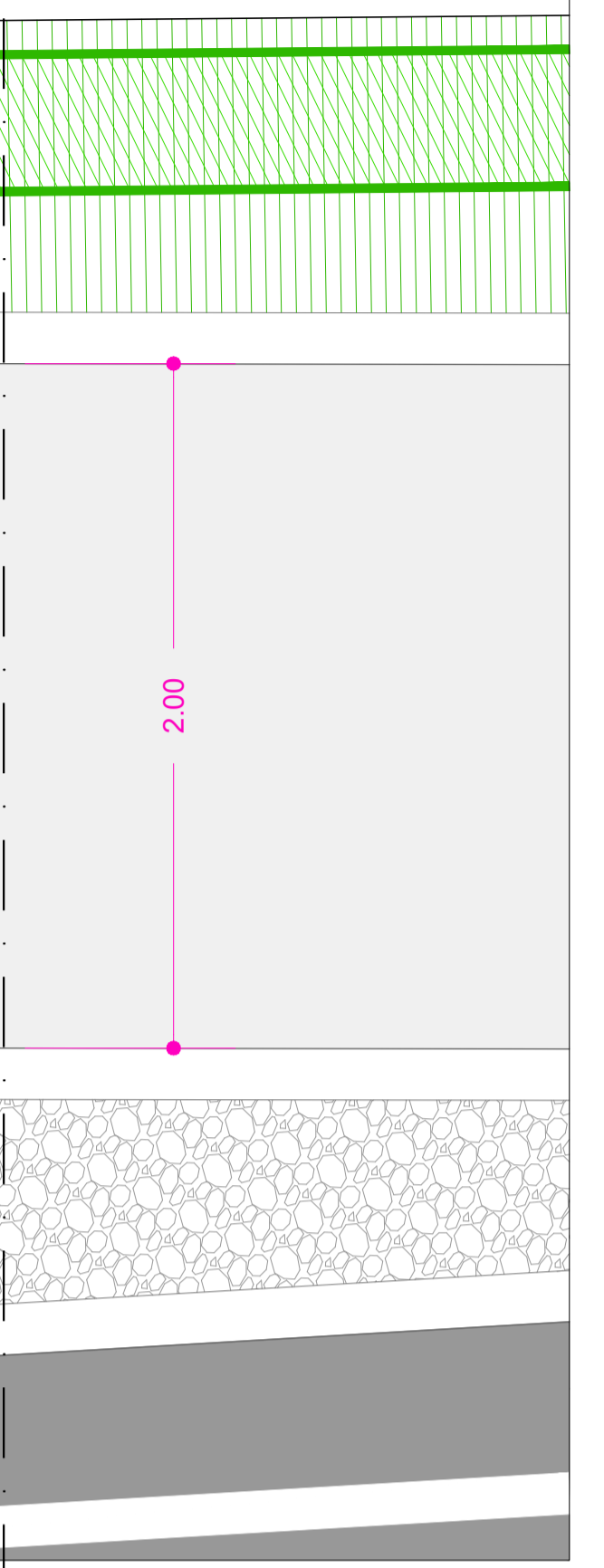

SEZ TIPO 03

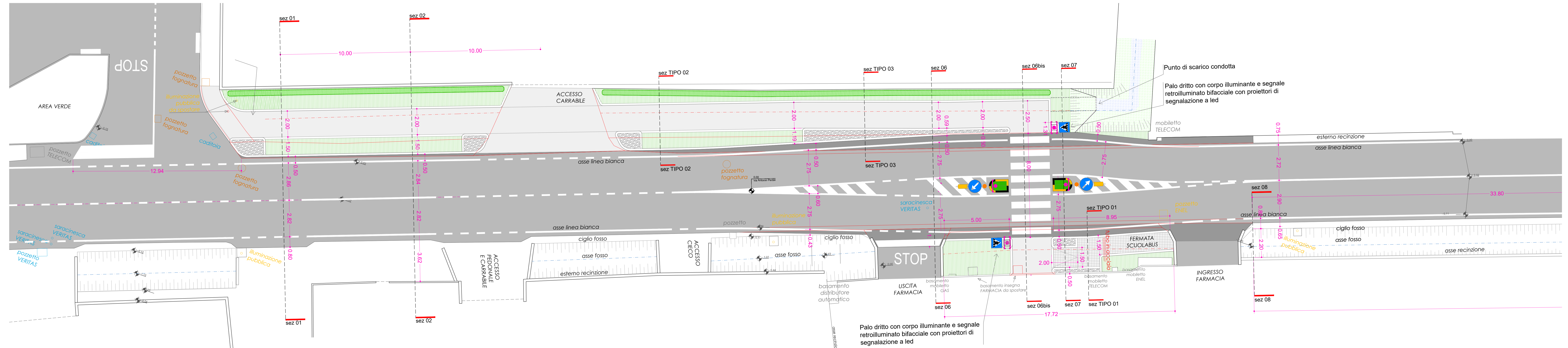
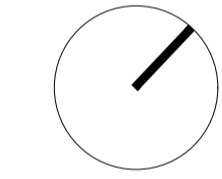

SEZ TIPO 03

PLANIMETRIA DI PROGETTO
1:100





COMUNE DI STRA
CITTA' METROPOLITANA DI VENEZIA

"Interventi a favore della mobilità e della sicurezza stradale
LR. 39/91 art. 9, DGRV n. 141/CR del 23.12.2019"
Realizzazione di un tratto di marciapiede e nuova isola
pedonale lungo la SP 21

- PROGETTO ESECUTIVO -

PROGETTO PLANIMETRIA E DETTAGLI		Scale 1:100/20
Committente	COMUNE DI STRA	
RUP	Arch. FABRIZIO BETTINI	
Progettista	Ing. GIOVANNI CARRARO	
Collaboratore	Arch. FEDERICO SANTELLO	
Data	Giugno 2023	
REV.		05

STUDIO TECNICO

Ing. Giovanni Carraro
Dott. degli Ingegneri Venezia n. 1494
30034 Mira (VI) - via Nazionale 172 - Tel./Fax 041/2900504 - Pagine NR 0412380372 - e-mail studio@giovannicarraro.com